



AIR PRESSURE REGULATOR Stainless Steel

SR67 G 1, G 1½)

Features

- 'Stainless' Pressure Regulator Model SR67 is designed as a high-performance product for instrument air use in corrosive atmospheres.
- Applications include marine environments, oil and gas production, chemicals and food processing, medical analysis etc.
- External Metallic parts meet NACE standard MR-01 75*
- CE, ATEX, EAC (Equivalent to GOST R&K) approved. All External parts are NACE MR 0175* approved.

(*National Association of Corrosion Engineers MR-01 75 defines requirements for sulphide stress cracking resistant materials used in oilwells and other corrosive environments.)

PARAMETERS	SPECIFICATIONS
Fluid	Compressed Air
Pipe Sizes	1", 1½"
Port Thread	NPT - Standard BSPT, BSP Optional
Max. Inlet Pressure	30 bar (435 psi)
Max. Operating Temp. (Ambient)	-20 to 80° C (Nitrile / EPDM / Viton/ Fluorosilicone Elastomer)
Material of Construction	Stainless Steel as per AISI 316
Body, Bonnet	SS 316 with NACE compliance (MR 0175)
Internal parts	SS 316/ SS 304
External parts	SS 316 with NACE compliance (MR 0175)
Diaphragm Assembly	Synthetic Rubber with PTFE - Standard
Elastomers	EPDM - Standard NITRILE, VITON, Fluorosilicone - Optional
Standard Nominal Flow Rate at 10 bar (150psi) inlet pressure 6 bar (87 psi) set pr. and a drop of 1 bar (14.5 psi) from set	1" - 381 scfm (181 dm ³ /sec) 1½" - 398 scfm (190 dm ³ /sec)
CV Value	1" - (5.39) 1½" - (7.51)
Type	Relieving - Std Non-Relieving - Optional
Pressure Adjustment	Hex Headed Adjusting screw - Standard 'T' Handle - Optional
Regulated secondary pressure ranges	1.00 - 10.0 bar (15 - 150 psi) - Standard 0.21 to 2.10 bar (3.0 - 30 psi) - Standard 0.40 - 4.0 bar (6.0 - 60 psi) - Optional 0.86 - 8.6 bar (12.5 - 125 psi) - Optional 1.70 - 17.5 bar (25 - 250 psi) - Optional
Gauge Port (2 nos.)	1/4" BSPT (Fe) - Std. 1/4" NPT (Fe) - Optional
Gauge size (dial size)	50 mm (Nominal)
Mounting	P.M. NUT - Standard Wall Mounting Bracket - Optional
Weight	6 Kgs.

Note :

- 1) Pressure gauge will be SS 2" dia 1/4" BC but will not be to NACE specification.
- 2) For optional versions please contact Sales HQ.
- 3) PM nut, mounting bracket will not be to NACE Specification.
- 4) Pressure gauge will not be ATEX approved.



Size	Flow	Range (psi)	Operation	Model
1" NPT	381 scfm (181 dm ³ /sec)	0 - 8.75 KG/CM ²	Relieving	SR67-801-RNLN-NHA
1½ NPT	398 scfm (190 dm ³ /sec)	0 - 8.75 KG/CM ²	Relieving	SR67-B01-RNLN-NHA



AIR PRESSURE REGULATOR Stainless Steel

SR67 G 1, G 1½)

Option Selector

Sample Model Number → **S R 6 7 - 8 0 0 - R G L A - N H A**
 Position → **0 1 2 3 - 4 5 6 - 7 8 9 10 - 11 12 13**

0 S = Shavo

1 Product Regulator

2 3 Series Larger Series - All SS 316 Unit

4 Port Size
 8 = 1"
 B = 1½"

5 6 Options

Elastomer	
[00]	= Nitrile
01	= EPDM
[02]	= Viton
[03]	= Fluorosilicone

7 Relief
 R = Relieving
 N = Non Relieving

8 Gauge
 N = No. Pr. Gauge
 G = With Pr. Gauge Fitted (S.S)
 SS 316 without ATEX approved

9 Sec. Pr. Range

C	0.21 to 2.10 bar (3.0 - 30 psi)
F	0.40 to 4.0 bar (6.0 - 60 psi)
L	0.86 to 8.6 (12.5 - 125 psi)
M	1.00 to 10.0 bar (15.0 - 150 psi)
[S]	1.70 to 17.5 bar (25.0 - 250 psi)

10 Port Thread

	Main Port	Gauge Port
A	NPT	BSPT
B	BSPT	BSPT
G	BSP	BSPT
N	NPT	NPT

11 Mounting & Accessories

N	= No Mounting Bracket
B	= Wall Mounting bracket (SS)



12 Pr. Adjustment
 H = HEX headed screw
 T = 'T' Handle

13 Service
 A = ATEX approved
 O = Other Customer Special requirement if any.

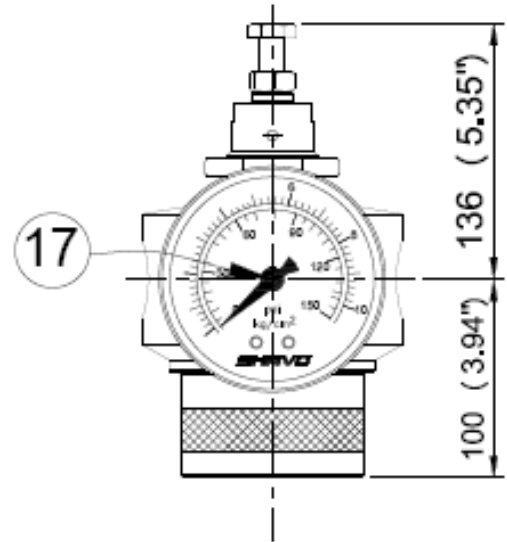
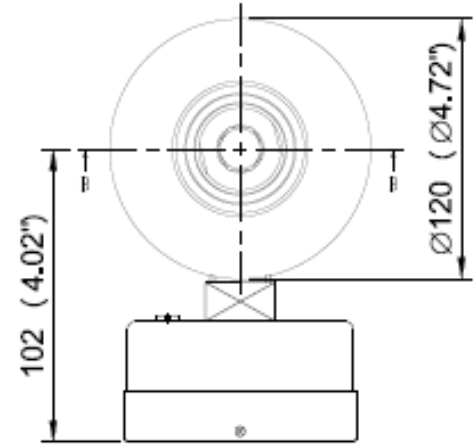

Features

- Stainless' Pressure Regulator Model SR67 is designed as a high-performance product for instrument air use in corrosive atmospheres.
- Applications include marine environments, oil and gas production, chemicals and food processing, medical analysis etc.
- External Metallic parts meet NACE standard MR-01 75*
- CE, ATEX, EAC (Equivalent to GOST R&K) approved. All External parts are NACE MR 0175* approved.

(*National Association of Corrosion Engineers MR-0175 defines requirements for sulphide stress cracking resistant materials used in oilwells and other corrosive environments.)

PARAMETERS	SPECIFICATIONS
Fluid	Compressed Air
Pipe Sizes	1/2", 3/4"
Port Thread	NPT - Standard BSPT, BSP Optional
Max. Inlet Pressure	30 bar (435 psi)
Max. Operating Temp. (Ambient)	-20 to 80° C (Nitrile / EPDM / Viton / Fluorosilicone Elastomer)
Material of Construction	Stainless Steel as per AISI 316
Body, Bonnet	SS 316 with NACE compliance (MR 0175)
Internal parts	SS 316/ SS 304
External parts	SS 316 with NACE compliance (MR 0175)
Diaphragm Assembly	Synthetic Rubber with PTFE - Standard
Elastomers	EPDM - Standard NITRILE, VITON, Fluorosilicone - Optional
Standard Nominal Flow Rate at 10 bar (150psi) inlet pressure 6 bar (87 psi) set pr. and a drop of 1 bar (14.5 psi) from set	1/2" - 218 scfm (104 dm ³ /sec) 3/4" - 360 scfm (171 dm ³ /sec)
CV Value	1/2" - (4.11) 3/4" - (6.80)
Type	Relieving - Std Non-Relieving - Optional
Pressure Adjustment	Hex Headed Adjusting screw - Standard 'T' Handle - Optional
Regulated secondary pressure ranges	1.0 to 10.0 bar (15.0 - 150 psi) - Standard 0.4 to 4.0 bar (6.0 - 60 psi) - Optional 0.86 to 8.6 bar (12.5 - 125 psi) - Optional 0.21 to 2.10 bar (3 - 30 psi) - Optional 1.70-17.5 bar (25-250 psi) - Optional
Gauge Port (2 nos.)	1/4" BSPT (Fe) - Std. 1/4" NPT (Fe) - Optional
Gauge size (dial size)	50 mm (Nominal)
Mounting	P.M. NUT - Standard Wall Mounting Bracket - Optional
Weight	2.10 Kgs.

Note :

- 1) Pressure gauge will be SS 2" dia 1/4" BC but will not be to NACE specification.
- 2) For optional versions please contact Sales HQ.
- 3) PM nut, mounting bracket will not be to NACE Specification.
- 4) Pressure gauge will not be ATEX approved.

Size	Flow	Range (psi)	Operation	Model
G 1/2	218 scfm (104 dm ³ /sec)	15-150 psi	Relieving	SR67-401-RNMAN-AH
G 3/4	360 scfm (171 dm ³ /sec)	15-150 psi	Relieving	SR67-601-RNMAN-AH



Option Selector

Sample Model Number → **S R 6 7 - 4 0 0 - R G L A - N H A**

Position → **0 1 2 3 - 4 5 6 - 7 8 9 10 - 11 12 13**

0 S = Shavo

1 Product R = Regulator

2 3 Series 67 = SS 316 (MOC)

4 Port Size
4 = 1/2"
6 = 3/4"

5 6 Options

Elastomer	
[00]	Nitrile
01	EPDM
[02]	Viton
[03]	Fluorosilicone

7 Relief
R = Relieving
N = Non Relieving

8 Gauge
N = No. Pr. Gauge
G = With Pr. Gauge Fitted (S.S)
SS 316 without ATEX approved

9 Sec. Pr. Range



F	0.4 - 4.0 bar (6.0 - 60 psi)
L	0.86 - 8.6 (12.5 - 125 psi)
M	1.0 - 10.0 bar (15.0 - 150 psi)
S	1.70 - 17.5bar (25.0 - 250 psi)
C	0.21 - 2.10 bar (3.0 - 30 psi)

10 Port Thread

	Main Port	Gauge Port
A	NPT	BSPT
B	BSPT	BSPT
G	BSP	BSPT
N	NPT	NPT

11 Mounting & Accessories

N	No Mounting Bracket
B	Wall Mounting bracket (SS)
P	2" Pipe Mounting Bracket Fitted (SS)

STANDARD
2" PIPE

12 Pressure Adj.
T = T handle (SS316)
H = Hex Headed Screw (SS316)

13 Test
A = ATEX approved
O = Other Customer Special requirement if any.

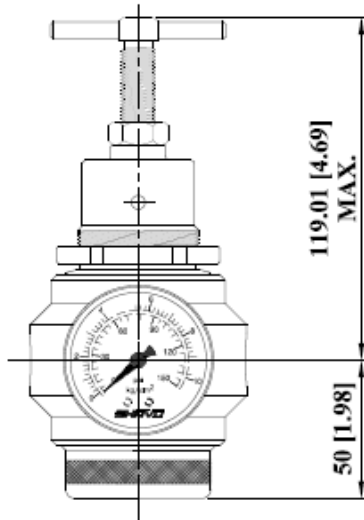
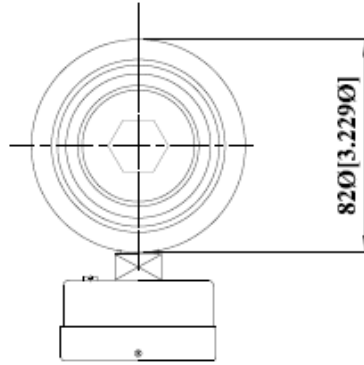

Note : Options shown in [] bracket are special, please consult manufacturing