

Product Data:-

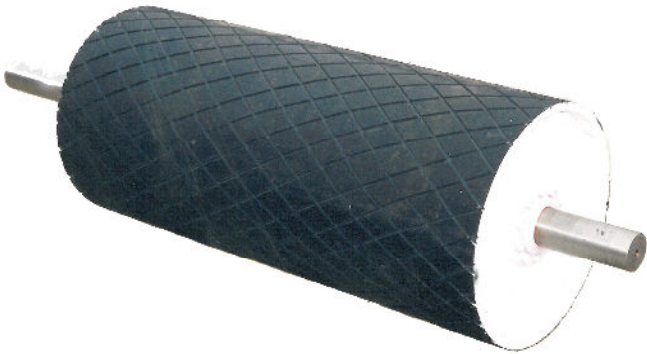

Preface:

Installed at the discharge end of flat or troughed belt conveyors, magnetic Head Rollers are designed to remove tramp iron that cannot be removed by either a Plate or Overband magnet due to the conveyed product depth.

Used in conjunction with the above mentioned units, magnetic Head Rollers will give the best possible protection against tramp metals.

These units are available in two magnetic materials, standard strength, which utilises Ceramic magnetic material and high strength, which utilises high intensity Rare Earth magnetic material, the later being the most popular due to it's high contamination removal efficiency.

Cleaning:

The unit is continually self cleaning with its own rotation. As the contamination enters the rollers magnetic field it is attracted and held firmly on the belt until it reaches the underside where it passes out of the magnetic field and is discharged separately from the conveyed product which continues on its normal trajectory.

Suitable Products:

All conveyable products, wood chip, biomass, recyclables, Aggregates, coal etc.

Suitable Locations:

Conveyor head roller.

Benefits:

- Allows difficult products to be screened
- High volume capacity
- Designed for 24/7 operation
- Removes large to medium sized contamination
- Continually cleans
- No running costs

Category:

Primary.



Technical Data:-

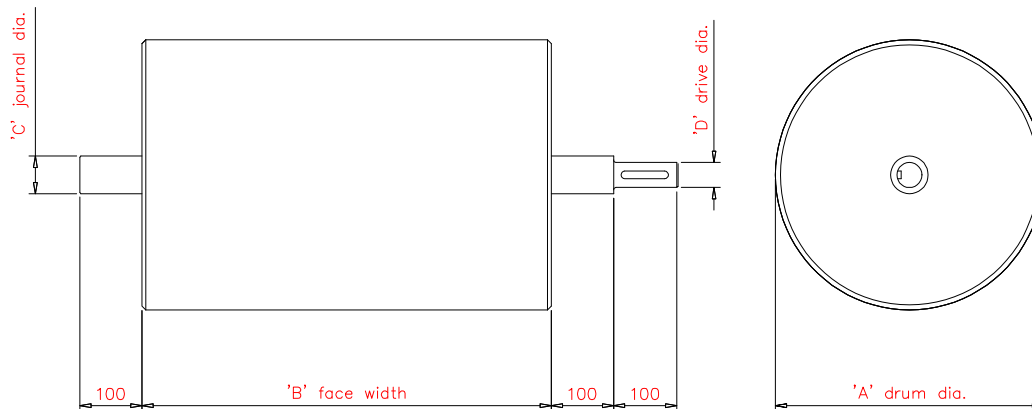

Sizes:-

| Part No | Dia A | Width B | Dia C | Dia D | Weight Kgs |
|-------------------|-------|---------|-------|-------|------------|
| 200 Series | | | | | |
| HRN2140 | 215 | 400 | 40 | 30 | 70 |
| HRN2150 | 215 | 500 | 40 | 30 | 80 |
| HRN2160 | 215 | 600 | 40 | 30 | 95 |
| HRN2170 | 215 | 700 | 40 | 30 | 110 |
| HRN2180 | 215 | 800 | 40 | 30 | 130 |
| HRN2190 | 215 | 900 | 40 | 30 | 145 |
| HRN21100 | 215 | 1000 | 40 | 30 | 160 |
| 300 Series | | | | | |
| HRN3140 | 315 | 400 | 50 | 40 | 110 |
| HRN3150 | 315 | 500 | 50 | 40 | 130 |
| HRN3160 | 315 | 600 | 50 | 40 | 150 |
| HRN3170 | 315 | 700 | 50 | 40 | 170 |
| HRN3180 | 315 | 800 | 50 | 40 | 190 |
| HRN3190 | 315 | 900 | 50 | 40 | 210 |
| HRN31100 | 315 | 1000 | 50 | 40 | 230 |
| 400 Series | | | | | |
| HRN4040 | 400 | 400 | 60 | 50 | 220 |
| HRN4050 | 400 | 500 | 60 | 50 | 260 |
| HRN4060 | 400 | 600 | 60 | 50 | 300 |
| HRN4070 | 400 | 700 | 60 | 50 | 340 |
| HRN4080 | 400 | 800 | 60 | 50 | 380 |
| HRN4090 | 400 | 900 | 60 | 50 | 420 |
| HRN40100 | 400 | 1000 | 60 | 50 | 260 |

Performance:-

All dimensions in mm

| | |
|------------------------------|--|
| Magnetic Performance: | 3,000 Gauss |
| Performance Reading: | On roller surface |
| Magnetic Material: | Rare Earth Neodymium Iron Boron |
| Magnet Grade: | N35 – Inspected & confirmed via hystergaph prior to use |
| Magnetic Field Depth: | 200 Series = 75mm – 300 Series = 100mm – 400 Series = 125mm* |
| Temperature: | -40° C/ + 80° C |

Materials:-

| | |
|--------------------|---------------------------|
| Cover: | 304 grade Stainless Steel |
| End Cheeks: | Painted Mild Steel |
| Shaft: | Mild Steel |

Options:-

Ceramic Magnetic Material
 Rubber lagged diamond cut cover
 Crowded detail
 Protective paint coating