

A•erity²⁰⁻³⁰

- World-class air filtration for industrial processes
- Long service intervals through EcoDrive® and Catch&Release®
- Connected for optimized performance and planned maintenance
- Upgradeable for changing process needs
- 8760 hours of maintenance-free operation

NEW POWERFUL FILTER UNIT FROM ABSOLENT

A•erity²⁰⁻³⁰ is a new, powerful filter unit for industrial operations that guarantees clean air for at least 8.760 operating hours. Thanks to our advanced filter technology, unplanned downtime is minimised, so you can focus on

your business. A•erity²⁰⁻³⁰ is based on tried and tested technology, developed with extensive expertise and ready for seamless integration into your production.

FUNCTION

A-erity²⁰⁻³⁰ is a multi-stage filter unit that filters and purifies polluted air from industrial processes. The contaminated air is drawn into the inlet at the bottom of the filter unit and passes through an Absolent filter cassette where most of the oil particles are captured. The filter becomes saturated with oil but is drained by the Absolent Catch & Release® function into the bottom part of the unit which is the collection vessel. The oil is then returned to the machine, an external tank or centralized purification system. The air continues through another Absolent filter cassette where the remaining larger particles are filtered out. Finally, it is transported through a HEPA H13 filter to the fan where the air is often so clean that it can be returned directly to the premises.

APPLICATIONS



Machining



Grinding

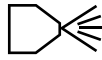

MQL

DIMENSIONS

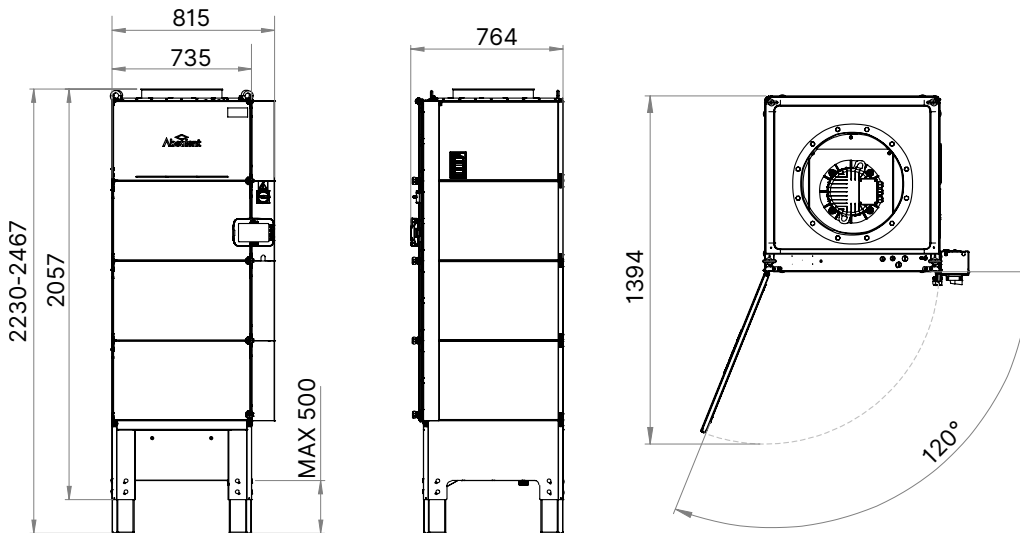

EQUIPMENT LEVELS



TECHNICAL SPECIFICATIONS

General

Product name	A•erity ²⁰⁻³⁰	
Application	Machining, grinding, MQL	
Nominal airflow	2000	m ³ /h
Particle load	30	mg/m ³
External pressure drop	1200	Pa
Energy class	IE5	
Colour	RAL 7035 SK-3	

Connections

Inlet type	S&W flanged pipe joint	
Inlet diameter	200	mm
Inlet placement	Back (std), optional left, right, front	
Outlet type	Essential: Free flow Professional, Advanced: S&W flanged pipe joint	
Outlet diameter	400	mm
Outlet placement	Top	
Drainage connection type	Threaded male (DN25)	
Drainage connection dimension	1	inch
Number of drainage connections	1	pcs
Drainage connection placement	Back right	

Filter

Number of filter stages per filter unit	3	pcs
Number of filter cassettes per filter unit	3	pcs
Filter cassette Stage 3	92120600 (HEPA H13)	
Filter cassette Stage 2	92110604	
Filter cassette Stage 1	92110639	
Prefilter	Yes, as option	

Fan

Fan motor type	EC	
Number of fans	1	pcs
Voltage	3x380-480 + N & PE	V
Frequency	50/60	Hz
Fan motor power	2,2	kW
Rated current	3,8	A
Maximum cable cross-section	6	mm ²
Rotational speed fan motor maximum	3000	RPM

Physical properties

Width without accessories/options	735	mm
Width with accessories/options	815	mm
Height without extension legs	2057	mm
Height with extension legs	2230-2467	mm
Depth	764	mm
Weight with empty filter cassettes	250	kg
Weight with full filter cassettes	280	kg
Weight without filter cassettes	200	kg

Sound level

Sound level Advanced 75% (normal operation)	64	db(A)
Sound level Professional 75% (normal operation)	64	db(A)
Sound level Essential 75% (normal operation)	71	db(A)

* The sound level is measured 1 m from the filter unit free field, hemispherical propagation. For sound calculation on specific room; contact Absolent or reseller/distributor.

COMPARISON EQUIPMENT LEVELS

A comparison for the different equipment levels Essential, Professional and Advanced. The different versions offer different degrees of configurability.

Design	Essential	Professional	Advanced
Sound level	On UI	On UI	On UI
Integrated rail		●	●
Ease of exterior cleaning		●	●
Hose protection		●	●
Door opening	Left	Left	Left
Control unit	Essential	Professional	Advanced
On/off handling fan	●	●	●
Visual filter alarms	●	●	●
Running indicator	●	●	●
Local/remote handling	●	●	●
Visual pressure drop		●	●
Visual thresholds		●	●
Visual alarm details		●	●
Visual target pressure		●	●
Visual current pressure		●	●
Total running hours		●	●
Calibration pressure		●	●
Adjustment of target 1		●	●
Adjustment of target 2/3		●	●
Configuration running parameter P, I, min, max			●
Configuration digital in			●
Configuration relay out			●
Thresholds adjustments			●
Individual filter hours			●
Configure number of filter stages			●
Factory reset			●
Parameter backup			●
Features	Essential	Professional	Advanced
Dashboard	No	Prepared	Yes
Modbus TCP/IP	●	●	●
0-10V output	●	●	●
Visual pressure drop, once every hour			●
Visual thresholds			●
Thresholds adjustments			●
Visual filter alarms			●
Visual alarm details			●
Running indicator			●
Visual target pressure			●
Adjustment of target 1			●
Adjustment of target 2/3			●
Visual current pressure, once every hour			●
Configuration running parameter P, I, min, max			●
Configuration digital in			●
Configuration relay out			●
Total running hours			●
Individual filter hours			●
Calibration pressure			●
Configure number of filter stages			●